

Brabender Loss-in-Weight Feeder Type DDW-MD2[3]-DDSR20-10Q[20]

The Brabender Loss-in-Weight Feeder Type DDW-MD2[3]-DDSR20-10Q[20] is the gravimetric version of the Brabender Twin-Screw Feeder DDSR20. Its compact dimensions and low feed rates make it best suitable for laboratory operation and small-capacity production lines.

Particularly the self-cleaning twin concave screws allow to feed powders with very poor flowability as well as adhesive, sticky or floodable ingredients. The little height and low centre of gravity permit to use a platform scale so that the feeding unit is freely accessible from all sides.

The Brabender Loss-in-Weight Feeder Type DDW-MD2[3]-DDSR20-10Q[20] consists of a platform scale with an integrated digital monobloc weighing module using the principle of two vi-

brating wires (DigiMASS-2), the Brabender Twin-Screw Feeder DDSR20 as feed module and an extension hopper of 10 or 20 dm³ volume, depending on refill method, feed rate and the required storage volume.

All modules are fully mounted and internally wired to junction boxes. In conjunction with a feed controller from the Congrav[®] microcomputer line or with feeder-mounted control and speed control modules "ISC" for the Brabender SCC Field Bus System they form a high-tech gravimetric feeder for utmost feeding accuracy. All parts in touch with the ingredient are made of stainless steel.

The unit conforms to CE directives.

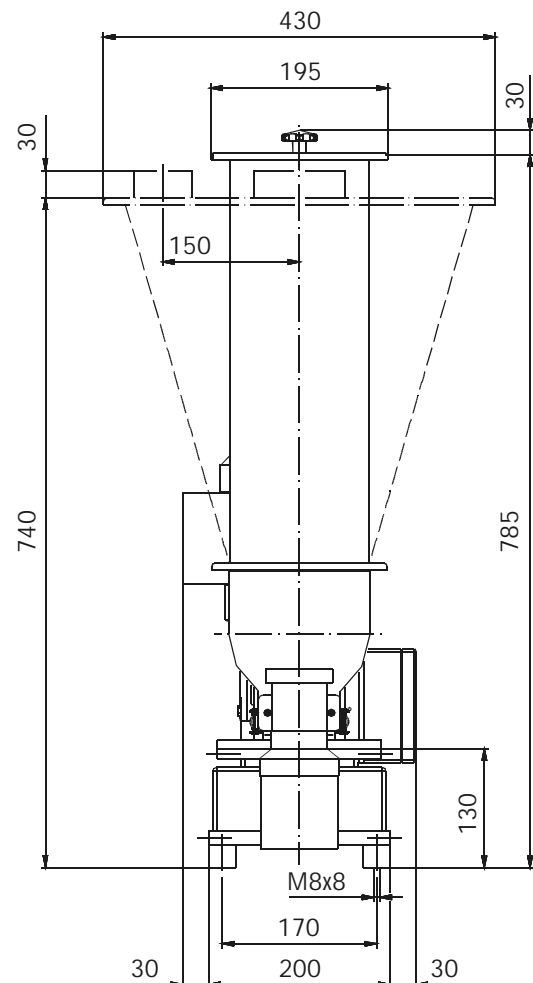
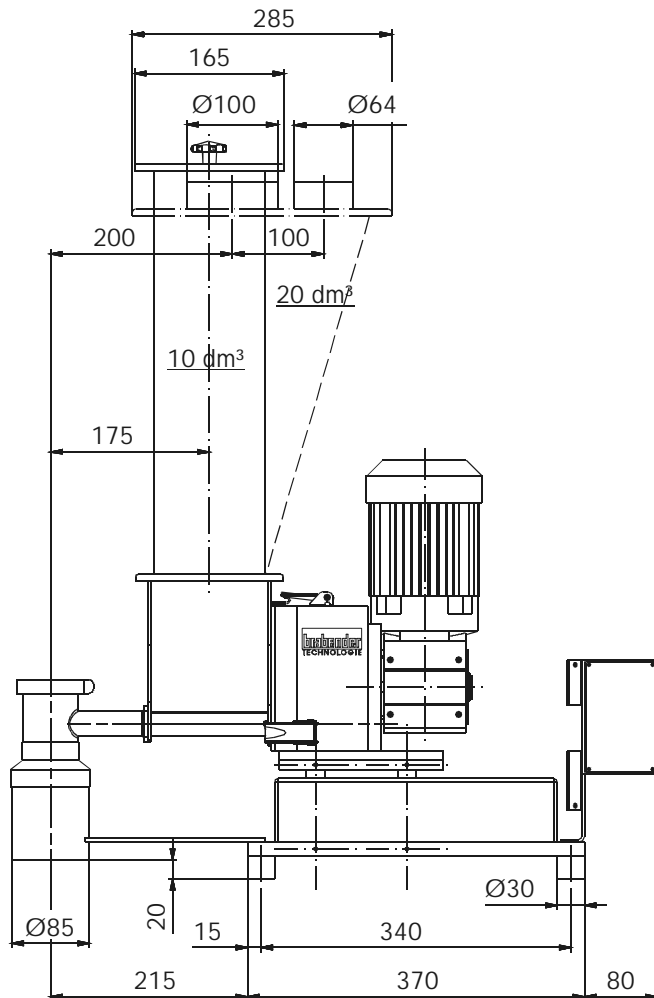
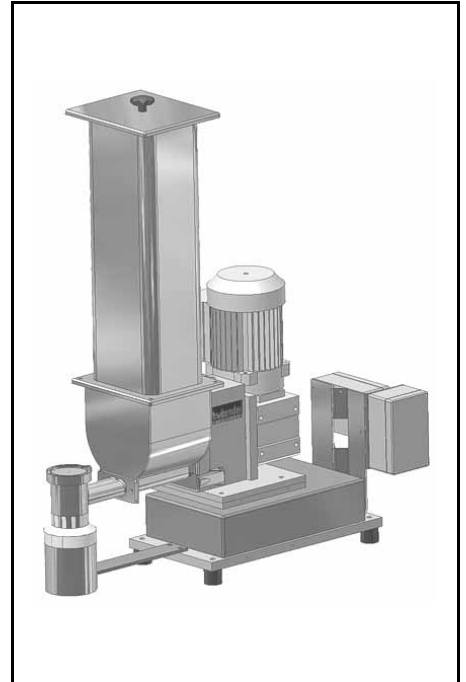

Weight with 10 dm³ extension hopper approx. 31 kg, with 20 dm³ extension hopper approx. 35 kg

Technical Data*

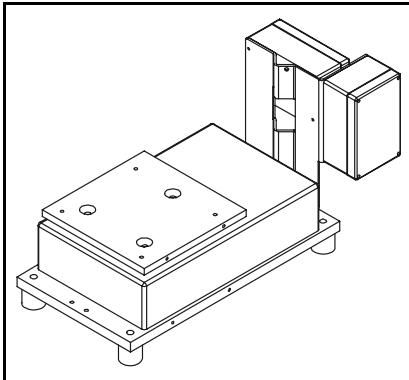

Scale

- Platform scale type MD2 or MD3 (depending on bulk density, feed rate and required storage volume)
- Built-in monobloc weighing module DigiMASS-2 with two vibrating wires using the principle of measurement by comparison of masses
- Junction boxes

Weighing ranges:

- 9 kg (MD2) or 24 kg (MD3) net with 10 dm³ extension hopper
- 5 kg (MD2) or 20 kg (MD3) net with 20 dm³ extension hopper

Further information: Brochure "DigiMASS-2 - Digital load cell with two vibrating wires"

Accessories / Options

- Discharge connection pipe for downstream equipment
- Exchange screws and tubes
- Hopper cover with handle
- Safety grid for hopper
- Mass plate to eliminate vibration

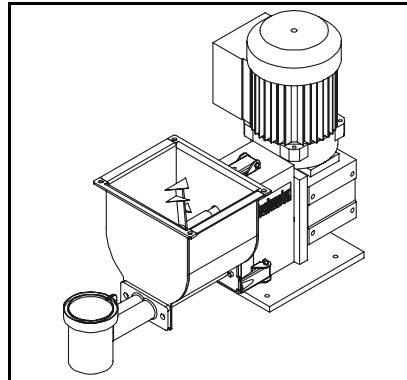

Feed Module

- Brabender Twin-Screw Feeder Type DDSR20
- Hopper agitator (driven via gearing)
- Frequency-controlled three-phase current motor
- Parts in contact with the ingredient SS 1.4301 (≈ AISI 304)

Max. theor. feed rate (assuming 100% screw filling; depending on ingredient flowability the actual rate may decrease down to 50 %):

- Twin spiral screw 335 dm³/h
- Twin concave screw 139 dm³/h

Further information: Works Standard "Brabender Twin-Screw Feeder Type DDSR20"

Special Designs

- Explosion-proof design
- Pressure-compensated design
- Version without scale for volumetric feeding (see Works Standard "Brabender Twin-Screw Feeder Type DDSR20")

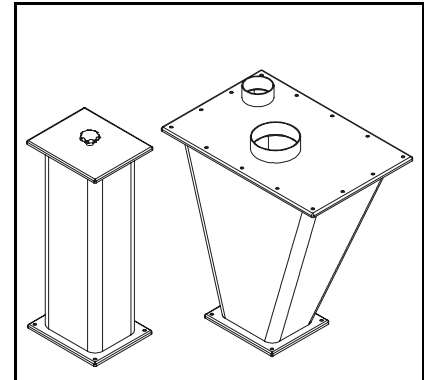

Extension Hoppers

- Rectangular hopper type 10Q with vertical walls for optimum ingredient flow
- Conical hopper for higher storage volume
- SS 1.4301 (≈ AISI 304)

Hopper volumes (suited to feed rate range):

- Rectangular hopper: 10 dm³
- Conical hopper: 20 dm³

Further information: Works Standard "Brabender Twin-Screw Feeder Type DDSR20"

Control Modules

Congrav[®] controller and frequency converter FC-V1.1 or Congrav[®] operating unit and feeder-mounted control and speed control modules "ISC" for Brabender SCC Field Bus System (see acc. Works Standards)

brabender

TECHNOLOGIE

An ISO 9001/EN 29001 Certified Company

*Modifications reserved. All data describe our products in a general manner. They are no agreement on or warranty of characteristics in the sense of § 434 or guarantee in the sense of § 443 of the German Civil Code or similar regulations and effect no liability.

Issue 2.0 (February 08)
Supersedes 3.0 (March 03)